



Revegetation Plan

Prepared for: Prasert Ngamsiripol
Prepared on: 12/24/2024
Site Address: 2755 73rd Ave. SE
Mercer Island, WA 98040



Prepared by: Clif Edwards
Certified Arborist PN-1983
Tree Risk Assessment Qualified
Seattle Tree Service Provider LIC-TSP-19824

Introduction

I was contacted by Daru Shi who is an architect for Prasert Ngamsiripol. Prasert is the owner of the property at 2755 73rd Ave SE in Mercer Island. A tree inventory, site map, tree protection plan, and replanting plan are requested as necessary documents for a development proposal. A site visit was arranged for Thursday December 19, 2024 at 10 am.

The International Society of Arboriculture's Best Management Practices: Managing trees during site development and construction, is used as a guideline.

Observations

Tree Inventory on page 6. Site Map on page 7.

12 trees over 10" in diameter, considered large trees by Mercer Island municipal code, are recorded on site or have canopy's that overhang the property. 9 trees are recorded on site and 3 trees are recorded off site. Of the 9 trees on recorded on site 5 are proposed for removal and 4 are proposed for retention. Retaining 30% of large trees on site during development is recommended. 5 trees on site are under 10" in diameter and are considered small trees. English Ivy is well established in tree canopies on portions of the property and limit full structural inspection.

Tree #1. Volunteer Black Walnut. Poor structure and growing in poor location on steep rock wall. Recommended for removal.

Tree #2. Black Locust. Codominant structure low on trunk. Ivy covers lower portion of tree.

Tree #3. English Laurel. Invasive species with off set suppressed canopy from larger nearby trees. Recommended for removal.

Tree #4. Black Walnut. Mature, healthy, wide spreading canopy.

Tree #5. Western Red Cedar. Off site tree with canopy overhang of property by 14'.

Tree #6. Japanese Maple. Tree is in good condition and in a good location for retention. Ivy covers lower portion of tree. Recommended for removal.

Tree #7. Western Red Cedar. Codominant structure is considered poor. Large root system currently at edge of house foundation and likely the cause of damage. Recommended for removal.

Tree #8. Western Red Cedar. Tree is in good condition and in a good location for retention. Ivy covers lower portion of tree.

Tree #9. Silver Birch. Off site tree with minor canopy overhang of driveway. Nearby in the ROW is another Birch tree with no canopy overhang, topped for utility clearance.

Tree #10. Big Leaf Maple. Off site tree with canopy overhang of E portion of property. Nearby in the ROW is another Maple tree with no canopy overhang, due to nearby tree competiion.

Tree #11. Western Red Cedar. Tree is in good condition and in a good location for retention.

Tree #12. Silver Birch. Tree is in poor condition due to nearby competition and likely BBB. This tree could be retained as a wildlife snag. Recommended for removal.

Tree Retention and Protection Plan

Avoid disturbance within the inner CRZ.

Tree #2. Create tree protection fencing at a 15' radius from trunk on the property, 75% of outer CRZ.

Tree #4. Create tree protection fencing at a 12' radius from trunk on the property, 75% of outer CRZ.

Tree #8. Create tree protection fencing at a 18' from trunk on the S portion of canopy, from the driveway to W edge of canopy.

Tree #9. Driveway protects root zone of tree. Avoid damage to trunk during development.

Tree #10. Install tree protection on the W side of the canopy on the property along driveway and near house. Areas of tree protection should be near the house while allowing access and demolition.

Recommended. The tree E of tree #10, E portion of the root area is used for parking. Further protection for this tree would be to install a wood border at edge of large roots on the E portion of root zone and fill root zone with mulch.

Tree #11. Install tree protection on the W side of the canopy at the tree's dripline. Trees low full canopy protects root zone. Areas of tree protection should be near the house while allowing access and demolition.

Tree Protection Detail

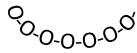
 -Tree protection fencing

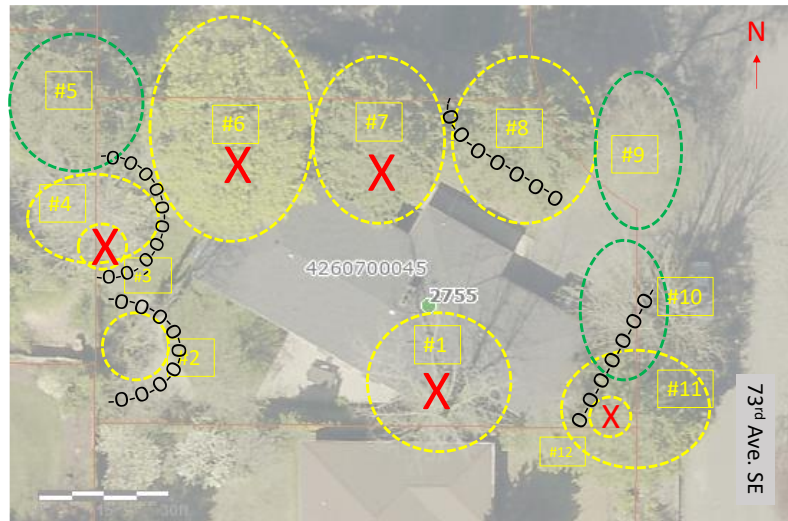

TREE & VEGETATION PROTECTION

TREE PROTECTION FENCING AND SIGN

1. CHAIN LINK FENCE REQUIRED (NO ORANGE CONSTRUCTION FENCE OR PLYWOOD)
2. MINIMUM 6' HIGH
3. FENCE SHALL BE SUPPORTED BY RIGID POSTS DRIVEN INTO THE GROUND AT 8' MAXIMUM INTERVALS
4. MUST BE INSTALLED PRIOR TO DEMOLITION OR GROUND DISTURBANCE
5. KEPT IN PLACE FOR THE DURATION OF CONSTRUCTION
6. NO DUMPING OF ANY MATERIALS IN THE PROTECTION AREA
7. NO SOIL DISTURBANCE OR ACTIVITY ALLOWED WITHIN FENCED AREA: MATERIAL STORAGE/STOCKPILING, PARKING, EXCAVATION, DUMPING, OR WASHING
8. MODIFICATIONS OF THESE REQUIREMENTS BY APPROVAL OF SDCI PLANNER ONLY
9. IF ROOTS GREATER THAN 2 INCH FOUND OUTSIDE OF FENCING, PROTECT BY HAND EXCAVATION AND, IF NECESSARY, CUT CLEANLY AND KEEP MOIST
10. USE 3 INCHES OR DEEPER WOOD CHIP MULCH OUTSIDE FENCED AREAS TO PROTECT FEEDER ROOTS

VEGETATION PROTECTION (DOES NOT APPLY TO TREES)

1. ORANGE MESH OR SIMILAR OPEN MATERIAL
2. PROTECT VEGETATION OUTSIDE CONSTRUCTION ZONE WITH FENCING AS SHOWN

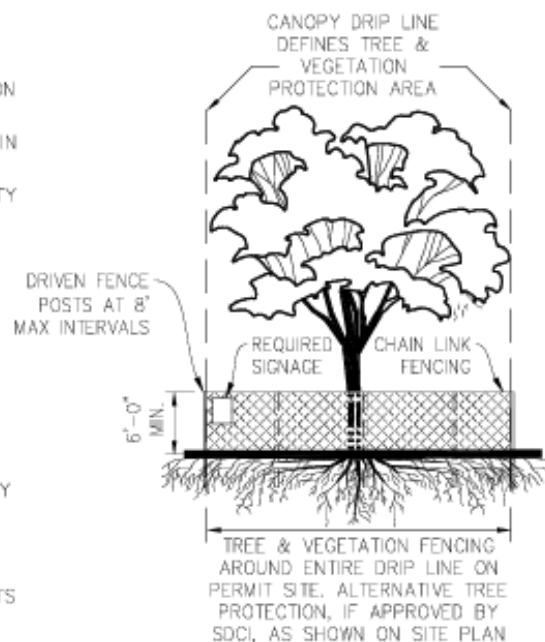

Revegetation plan

Replanting map on page 8.

Tree replacement follows Mercer Island municipal code 19.10.070.

Trees need to be planted during the wet season (October 1- April 1). Trees need to be maintained in healthy condition for a 5 year period. Dead trees require replacement during the 5 year period. Replacement tree numbers are determined from the table below.

Diameter of removed tree	Number of replacement trees required
Less than 10 inches	1
10 inches up to 24 inches	2
24 inches up to 36 inches	3
More than 36 inches and any exceptional tree(s)	6

18 trees are required replacement for the proposed tree removals.

Deciduous trees need to be a minimum size 1.5" caliper stem.

Evergreen trees need to be a minimum size 6' tall.

Tree Inventory

Tree ID #	Common name	Genus species	DSH"	Inner CRZ	Outer CRZ	Canopy Diameter	Health/Condition	Status	Location
1	Black Walnut	<i>Juglans nigra</i>	17.6"	9'	18'	50'	good vigor, poor location and structure	Remove	On site
2	Black Locust	<i>Robinia psuedoacacia</i>	19.5"	10'	20'	30'	good vigor, remove ivy for inspection	Retain	On site
3	English Laurel	<i>Prunus laurocerasus</i>	11.4"	5.75'	11.5'	22'	good vigor, suppressed by nearby tree	Remove	On site
4	Black Walnut	<i>Juglans nigra</i>	16.0"	8'	16'	50'	good vigor and structure	Retain	On site
5	Western Red Cedar	<i>Thuja plicata</i>	30"	15'	30'	50'	good vigor and structure	Retain	Off site
6	Japanese Maple	<i>Acer palmatum</i>	32.2"	16'	32'	55'	good vigor, remove ivy for inspection	Remove	On site
7	Western Red Cedar	<i>Thuja plicata</i>	51.9"	26'	52'	40'	good vigor, poor structure	Remove	On site
8	Western Red Cedar	<i>Thuja plicata</i>	36.2"	18'	36'	44'	good vigor, remove ivy for inspection	Retain	On site
9	Silver Birch	<i>Betula pendula</i>	19.9"	10'	20'	40'	good vigor, good response to BBB	Retain	Off site
10	Big Leaf Maple	<i>Acer macrophyllum</i>	20.9"	10.5'	21'	25'	good vigor	Retain	Off site
11	Western Red Cedar	<i>Thuja plicata</i>	27.6"	14'	28'	44'	good vigor and structure	Retain	On site
12	Silver Birch	<i>Betula pendula</i>	10.3"	5'	10'	8'	poor condition/ suppressed	Remove	On site

Trees proposed for removal

Trees proposed for retention

Off site trees



Site Map

2755 73rd Ave SE
Mercer Island, WA 98040
Parcel # 4260700045

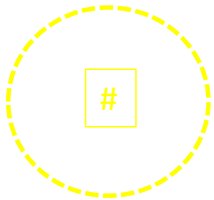

-On site trees and approximate canopy area.

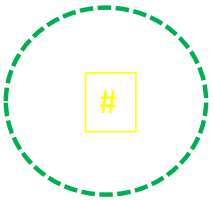

-Off site trees and approximate canopy area.



-Trees proposed for removal.



